

BLAUPUNKT

ESTABLISHED
IN
GERMANY
Since 1923

ROOF MONITOR ROME 900 RM



Enjoy it.

Operating and installation instruction

Content

1. Cautions	2
2. Main Unit Structure	3
3. Remote Control Structure	4
4. Power Supply Operation	4
5. Source Selection	5
6. Photo File Operations	5
7. Music File Operations	5
8. Video File Operation	6
9. Text File Operations	6
10. Menu Setting	7
11. Supported Formats	7
12. Product Specifications	8
13. Installation Instructions	9
14. Troubleshooting	12
15. Accessories	13

Cautions

Please read this carefully before using the product.

- This manual is used to protect users from any personal or property damage. The Attention icons display the method of safe product usage.
- Driver should not be watching TV / Video or operating the device when driving.
- This product is applicable for 12V vehicle use only. Voltage difference may lead to fire and electric shock.

Attentions



- Protect power line from damages such as folding, tangle, stretch, bending, pulling or heating.
- Fasten seat belt when watching from the rear seat.
- Do not apply heavy pressure on the device. Do not drop the device. Heavy impact on the device may break the LCD or the entire device.



- Wrong/inappropriate operation may cause casualty due to electric shock or endangering others and properties.
- Wiring and installation should be performed by experience and professional technicians.
- Fastened the lead correctly to prevent loose screws and rails.
- Please turn down the sound volume before shutting down device to prevent hearing damage.
- Regularly clean and check the connecting part of power line to prevent dust, dirt or any objects from covering the power supply, do not cover or block the vent hole, which may lead to fire when overheat.
- Device position should not restrict driver's movement or distract driver. To prevent accidents and injuries, it is recommended to position device away from driver such as steering wheel, shift lever, handbrake areas or front windshield area. Device may cause injury in case of braking if not installed correctly.
- Use rated voltage fuse box (2A) only to prevent damage to device.
- Use only specified wire to avoid damage of power supply or catching fire.



- Pay attention to electric shock.



- Do not disassemble, reinstall, repair or modify device without authorised consent. Please consult professional technicians. Inappropriate dismantling may cause electric shock and fire.



- Immediately disconnect power supply in case of smoke appearing or any abnormal sound, this is to prevent fire or electrical shock.



- Keep device at cool and dry place to prevent device from catching fire, sending electric shock, discolouration and deformation.



- Do not touch the product or the power plug after thunder to prevent electric shock.

Disclaimer : Company is not liable for casualty caused by faulty device or inappropriate use of this product.
Content and instruction may change without prior notice.
Please check if product is suitable for the vehicle before installation.

Main Unit Structure

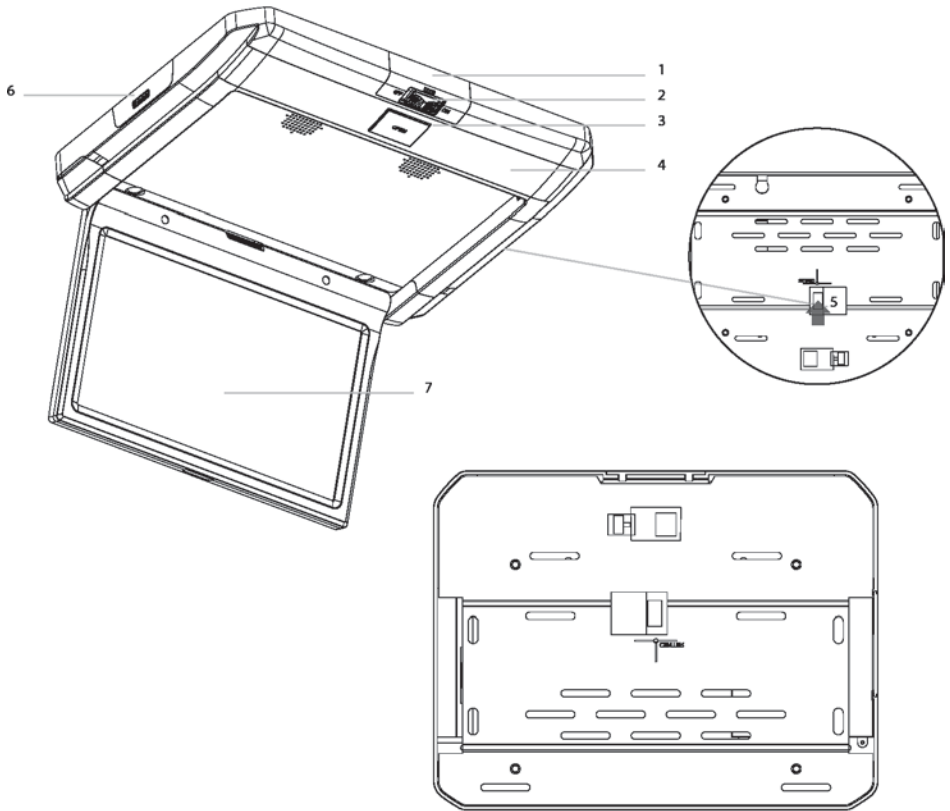

1. Remote Control Receiver
2. Dome Light switch (Switch to LEFT to turn off dome light, MIDDLE for auto dome light setting and RIGHT to turn on dome light)
3. Screen Lock
4. LED Dome Light
5. Power Signal Line Connecting Port
6. Mini SD Card Slot
7. LCD Display Panel

Remote Control Structure

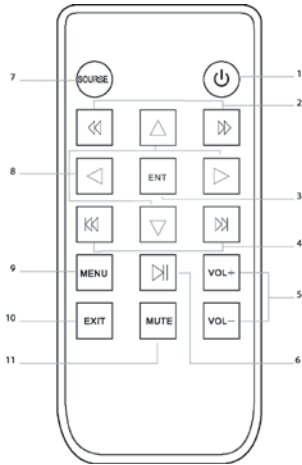

1. Power for startup/shutdown
2. Fast Backward / Forward (Speed x1, x2, x4, x8, x16)
3. Enter to confirm selection
4. Previous / Next
5. Volume Up / Down
6. Play / Pause
7. Source for signal selection
8. Up / Down / Left / Right Cursor
9. Menu
10. Exit
11. Mute



Remove transparent sheet at the lower part of the battery before using the remote control. Users are advised to replace battery with CR-2025 for optimum usage. Life span for CR-2025 battery is approximately 1-year and below.

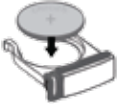

Pull battery tray out to replace battery.



The effective range of remote control with main unit is 3 meter without barrier.

Keep remote control at cool and dry place to prevent any damages to the device itself and the battery.

Power Supply Operation

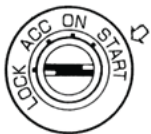

Please start car engine before using the device.

Device will automatically turn on when screen is unlocked.

Or click on the remote control's power key to turn on the device in case device did not turn on automatically.



Adjust the screen angle to optimal visual angle after unlocking the screen. The screen can be opened to 180°. This is for collision safety purpose, it prevents passengers from crashing into the screen.

Use remote control's power key to shut down the device or carefully close the screen until 'clicking' sound appear; the device will turn off automatically.

Operations

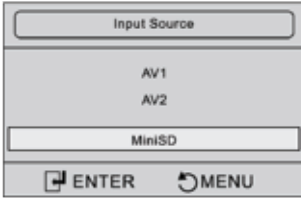

Source Selection

Accessible to 3 channels : AV1, AV2, MiniSD/MicroSD
Click source key in the remote control to select the input source.
Attention :
Default setting plays AV1 signal. The device memory is capable of replaying the last changed source when it is turned on again.



Photo File Operations

Click Enter key on remote control to enter following Menu Screen, use Exit key to leave the Menu Screen. Use up and down key to select to view Photo / Music / Movie / Text Files.



After selecting Photo folder, use up and down key to select file and Enter key to preview images. Use Exit key to exit back to File Menu.



Music File Operations

Use the up and down keys to select music. Access the folder to preview and display the music files.



Access to Music folder to preview list of song and display details of music files.



Screen will display song's details and timer shaft after it is selected.

Operations



Video File Operations

Use the up and down keys to select Movie. Access the folder to preview and display the video files.



Access to Movie folder to preview list of video and display details of video files.



Text File Operations

Use the up and down keys to select Text. Access the folder to preview and display the text files.



Access to Text folder to preview list of text and display details of text files.

Operations

Menu Setting

Setting Category	Sub-category	Setting Value
Picture	Picture mode	Dynamic / Standard / Mild / User
	Contrast	0 ~ 100
	Brightness	0 ~ 100
	Colour	0 ~ 100
	Sharpness	0 ~ 100
	Colour temperature	Standard / Warm / User / Cool
	Aspect ratio	16:9 / Auto / 4:3
	Noise reduction	Off / Low / Middle / High
Sound	Sound mode	Standard / Music / Movie / Sports / User
	Treble	0 ~ 100
	Bass	0 ~ 100
	Balance	-50 ~ +50
	Auto volume	On / Off
	Surround sound	On / Off
	Equalizer	120Hz / 500Hz / 1.5KHz / 5KHz / 10KHz
Time	Clock	Time
	Sleep timer	Off / 10 / 20 / 30 / 60 / 90 / 120 / 180 / 240min
	Auto sleep	On / Off

Supported Video Format

Expanded-name	Sub-category	Setting Value	Setting Value
.dat / .mpg / .mpeg	MPEG 1,2	1920 x 1080 30fps	20Mbit/sec
.ts	MPEG2, H.264	1920 x 1080 30fps	20Mbit/sec
.vob	MPEG2, H.264	1920 x 1080 30fps	20Mbit/sec
.mp4	MPEG4 Divc3.11, Divx4.12 Divcx5.x, Divx6 Xvid1.00, Xvid1.01 Xvid1.10-beta 1/2 H.264	1920 x 1080 30fps	20Mbit/sec
.rb / .rmvb	rm code Rv8 RV9, RV10	1280 x 720 30fps	10Mbit/sec
.mkv	H.264, MPEG1,2,4	1920 x 1080 30fps	20Mbit/sec
.divx / .avi	MPEG2, MPEG4 Divx3.11, Divx4, Divx5, Divx6 Xvid1.00, Xvid1.01 Xvid1.02, Xvid1.003 Xvid1.10-beta 1/2 H.264	1920 x 1080 30fps	20Mbit/sec
.asf	Vc1	1920 x 1080 30fps	20Mbit/sec

Operations

Attention : Some files may not be supported.

Supported Audio Format

File Format	Bit Rate
MP3	32Kbps~320Kbps
MWA	32Kbps~320Kbps
.vob	MPEG2, H.264

Attention : Some files may not be supported and WMA files with copyright protection is not supported.

Supported Picture Format

File Format	JPEG, PNG, BMP
Recommended Resolution	1024x600

Attention : Some file may not be supported and recommended to play 1024x600 resolution file.

Product Specifications

Description	ROME 900 RM
Screen	10.1" WSVGA LED backlight LCD screen
View Angle	50° / 70° / 70° / 70° (Up / Down / Left / Right)
Display ratio	16:09
Input	AV1 / AV2 / Mini SD
Adjusted screen angle	0° ~ 180°
Spare part voltage	DC12V (Negative ground) / 1A
Room light	DC12V/0.3A
Power consumption	About 15W
Running temperature	0° ~ 50°
Storage temperature	-10° ~ +60°
Size (mm)	316 (L) x 241 (W) x 33 (H)
Weight (kg)	1.7
Colour	Black
Operation mode	Remote Control

Installation Instruction

Accessories for installation



Power Signal Cord



Roof Monitor

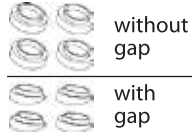

Rubber Plug



Buffer Belt

Wiring Connection Method

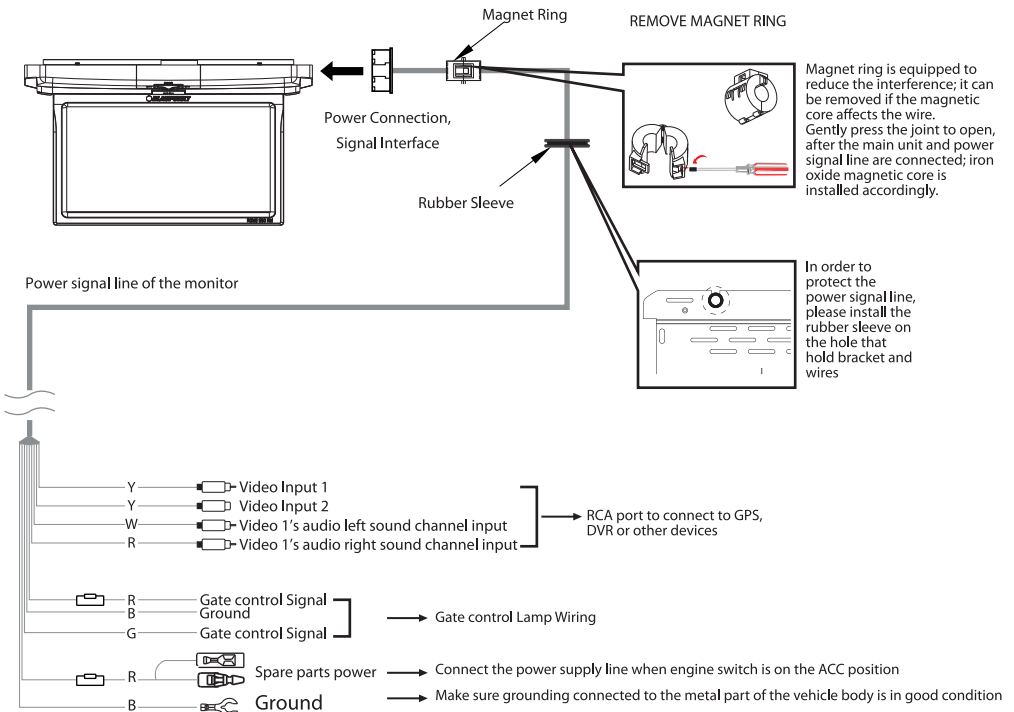

Installation Instruction

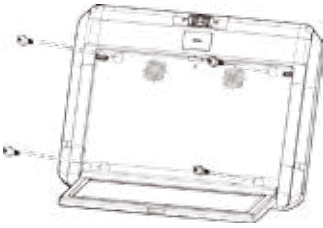

1. Separate the stand from the main unit by removing the 4 screws.
2. Mark the position of the unit in the middle, with similar space measurement on each side. Cut the marked ceiling carpet out.

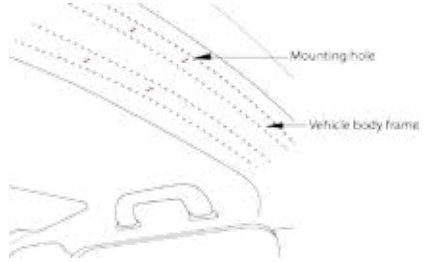

Attention

- Any alteration of the vehicle might result in void of manufacturer's warranty.
- Our company is not liable for any vehicle accessories repair and replacement.
- Shape and position of mounting holes vary from one manufacturer to another.
- Our company does not guarantee if this product applies to all type of vehicles.

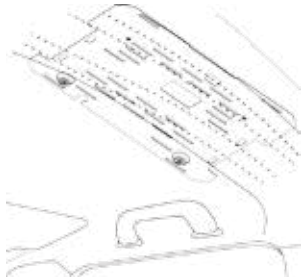

3. Please pay attention to the installation guide.
4. Choose the elongated holes on the stand that is located in the same place with the mounting holes on both side of vehicle.

Attention :

- Do not use screws that are longer than the stand in order to prevent damages to vehicle.
- Do not use screws that are smaller than the screw hole on both sides of vehicle.
- All 4 screws must be fixed on the stand.

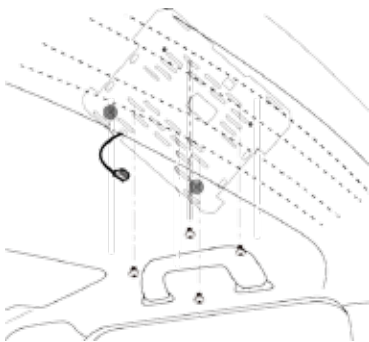
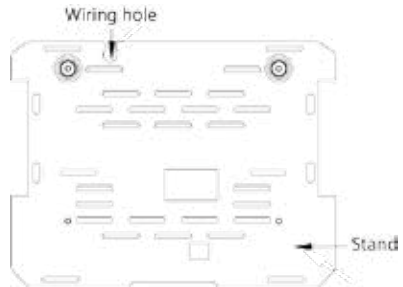

5. Choose suitable size of screw to install the stand.
6. Before tightening the screw on the stand, pull the wire rod of the wire hole out.

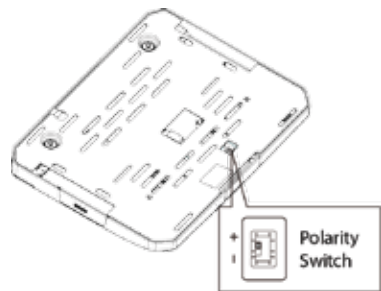

Gate control lamp polarity switch adjustment :

Different vehicles will have different gate control polarity. Please shift switch according to specific case.

- [Positive Pole] Signal is 12V when operating.
- [Negative Pole] Signal is Ground when operating.

Attention :

Please set the polarity switch of the gate control lamp correctly before installation. Wrongly set polarity would lead to light failure.

Installation Instruction

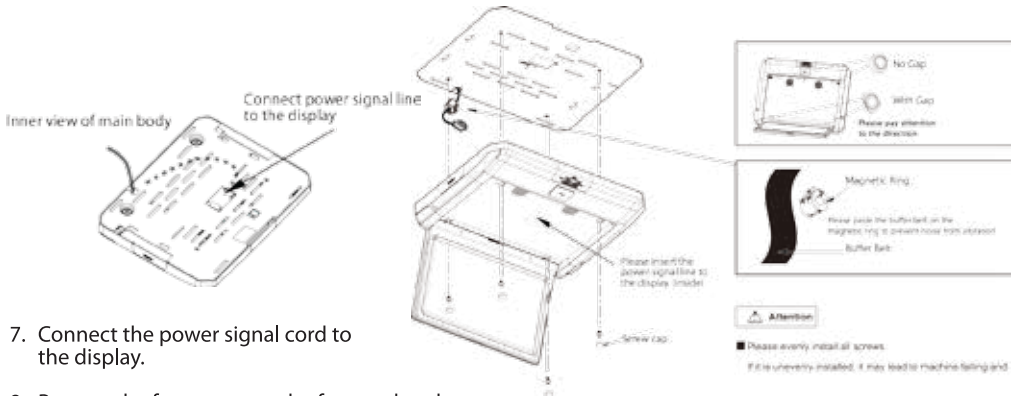

7. Connect the power signal cord to the display.
8. Prepare the four screws to be fastened to the main unit and stand before using.
9. Cover the screw cap.

Attention :

- Product must be installed correctly and screws must be tightened evenly.
- Loose screws may lead to injury caused by fallen unit.

Troubleshooting

Conditions / Problems	Possible Causes and Solutions
No power supply	<ul style="list-style-type: none">• Was the power supply connection well intact?• Is the +12V ACC (red line) correctly connected?• Is the ground line (black line) connected to the metal part of vehicle?• Is the fuse box's wire burnt?
No image	<ul style="list-style-type: none">• Is the connection well joint?• Is the video input switched to the correct signal source?
Abnormal image colour, dark or light display	<ul style="list-style-type: none">• Please adjust the contrast and the brightness.• It may be caused by the rear light.• Is the fuse box's wire burnt?
Remote control not functioning	<ul style="list-style-type: none">• Is the battery placed correctly?• Over battery service life.• Is the remote being operated facing the unit?• Is the remote's signal detector facing having light interference such as sunlight or car light?

Accessories

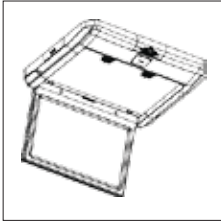

Roof Monitor



Remote Control

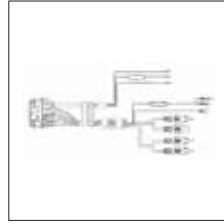

Power Signal Cord

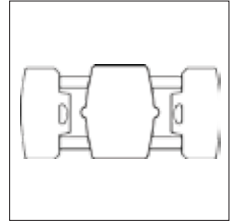

3 x Connector

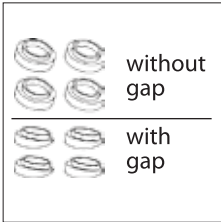

4 x Rubber Plug
with Gap

4 x Rubber Plug
without Gap

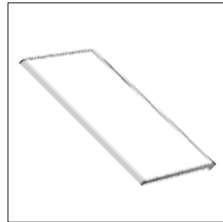

Buffer Belt



Manual

